

BHE 40~135

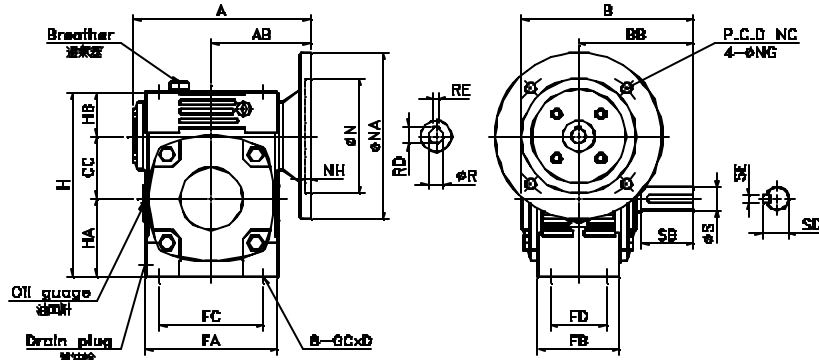

BHE 80 - 60 AR - 1HP
1 2 3 4 5

1. (Type)
2. (Size)
3. (Ratio)
4. (S. L.)
5. (Power)



S.L. (Shaft Location)

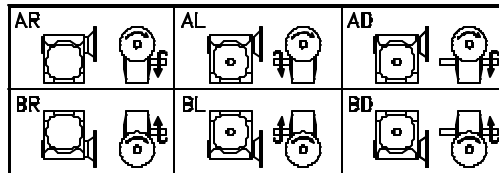

BHEO 50~135



BHEO 80 - 60 A - 1HP
1 2 3 4 5

1. (Type)
2. (Size)
3. (Ratio)
4. (S. L.)
5. (Power)

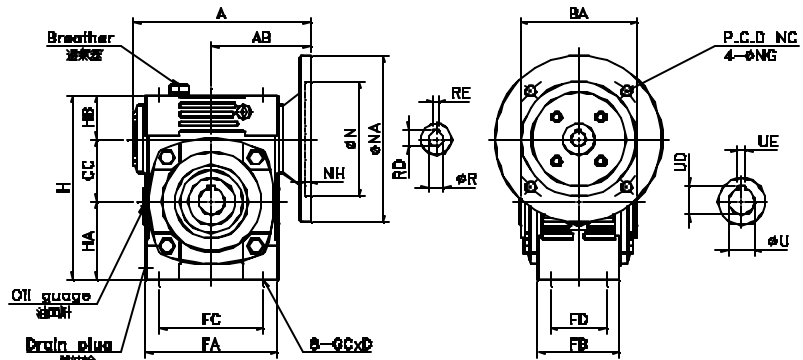

S.L. (Shaft Location)

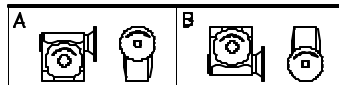

Dim. Table

| Size | Ratio | A | AB | B | BA | BB | CC | FA | FB | FC | FD | GCxD | H | HA | HB | (^l) | (kg) |
|------|-------|-----|-----|-----|-----|-----|-----|-----|-----|-----|-----|---------|-----|-----|-----|------------------|------|
| 40 | 1:10 | 150 | 89 | 130 | - | 84 | 40 | 102 | 68 | 80 | 54 | M8x16L | 127 | 53 | 34 | 0.18 | 5.0 |
| 50 | 1:15 | 163 | 85 | 145 | 95 | 95 | 50 | 115 | 68 | 90 | 50 | M8x16L | 150 | 65 | 35 | 0.31 | 5.8 |
| 60 | 1:20 | 177 | 90 | 165 | 112 | 110 | 60 | 127 | 78 | 100 | 54 | M10x20L | 177 | 75 | 42 | 0.44 | 7.1 |
| 70 | 1:30 | 211 | 117 | 195 | 131 | 130 | 70 | 156 | 88 | 125 | 66 | M10x20L | 205 | 85 | 50 | 0.70 | 13.0 |
| 80 | 1:40 | 233 | 129 | 210 | 144 | 140 | 80 | 176 | 101 | 145 | 75 | M10x20L | 232 | 92 | 60 | 0.99 | 18 |
| 100 | 1:50 | 286 | 160 | 260 | 175 | 170 | 100 | 227 | 112 | 185 | 85 | M12x24L | 290 | 115 | 75 | 1.9 | 36 |
| 120 | 1:60 | 349 | 180 | 290 | 200 | 190 | 120 | 265 | 132 | 220 | 100 | M14x28L | 370 | 155 | 95 | 4.1 | 55 |
| 135 | | 373 | 201 | 320 | 216 | 210 | 135 | 298 | 144 | 260 | 110 | M16x32L | 425 | 185 | 105 | 4.4 | 75 |

| Size | Ratio | Input Bore | | | Input Adapter | | | | Output Shaft | | | | Output Hollow | | | Power | |
|------|-------|------------|------|----|---------------|-----|-----|----|--------------|-------|----|----|---------------|----|------|-------|--------|
| | | R | RD | RE | N(h7) | NA | NC | NG | NH | S(h8) | SB | SD | SE | U | UD | | UE |
| 40 | 1:10 | 11 | 12.8 | 4 | 110 | 160 | 130 | 10 | 5 | 15 | 35 | 17 | 5 | 20 | 23 | 6 | 0.25HP |
| 50 | 1:15 | 11 | 12.8 | 4 | 110 | 160 | 130 | 10 | 5 | 17 | 40 | 19 | 5 | 25 | 28 | 7 | 0.25HP |
| 60 | 1:20 | 11 | 12.8 | 4 | 110 | 160 | 130 | 10 | 5 | 22 | 50 | 25 | 7 | 25 | 28 | 7 | 0.25HP |
| | 1:30 | 14 | 16.3 | 5 | 110 | 160 | 130 | 10 | 5 | 22 | 50 | 25 | 7 | 25 | 28 | 7 | 0.5HP |
| 70 | 1:40 | 14 | 16.3 | 5 | 110 | 160 | 130 | 10 | 5 | 28 | 60 | 31 | 7 | 30 | 33 | 7 | 0.5HP |
| | 1:50 | 19 | 21.8 | 6 | 130 | 200 | 165 | 12 | 5 | 28 | 60 | 31 | 7 | 30 | 33 | 7 | 1HP |
| 80 | 1:60 | 19 | 21.8 | 6 | 130 | 200 | 165 | 12 | 5 | 32 | 65 | 35 | 10 | 35 | 38 | 10 | 1HP |
| | | 24 | 27.3 | 8 | 130 | 200 | 165 | 12 | 5 | 32 | 65 | 35 | 10 | 35 | 38 | 10 | 2HP |
| 100 | | 24 | 27.3 | 8 | 180 | 250 | 215 | 15 | 5 | 38 | 75 | 41 | 10 | 40 | 43 | 12 | 2HP |
| | | 28 | 31.3 | 8 | 180 | 250 | 215 | 15 | 5 | 38 | 75 | 41 | 10 | 40 | 43 | 12 | 3HP |
| 120 | | 28 | 31.3 | 8 | 180 | 250 | 215 | 15 | 5 | 45 | 85 | 48 | 12 | 45 | 48.5 | 14 | 3HP |
| | | 28 | 31.3 | 8 | 180 | 250 | 215 | 15 | 5 | 45 | 85 | 48 | 12 | 45 | 48.5 | 14 | 5HP |
| 135 | | 28 | 31.3 | 8 | 180 | 250 | 215 | 15 | 5 | 55 | 95 | 60 | 15 | 55 | 60 | 15 | 5HP |
| | | 38 | 41.3 | 10 | 230 | 300 | 265 | 15 | 5 | 55 | 95 | 60 | 15 | 55 | 60 | 15 | 7.5HP |