

TKAE 50~135

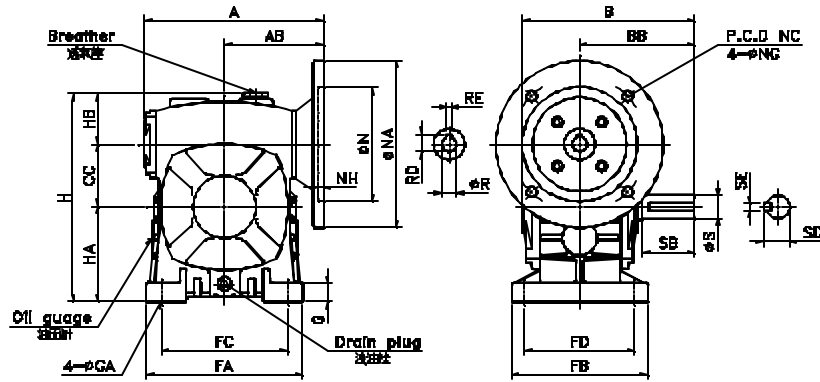

TKAE 135 - 60 R - 5HP  
 1 2 3 4 5

1. (Type)
2. (Size)
3. (Ratio)
4. (S. L.)
5. (Power)



S.L. (Shaft Location)

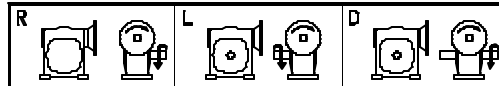

Dim. Table

Size	Ratio	A	AB	B	BB	CC	FA	FB	FC	FD	G	GA	H	HA	HB	( l )	( kg )
50	1:10	163	85	145	95	50	140	120	110	95	15	11	180	80	50	0.31	66
60	1:15	177	90	165	110	60	150	130	120	105	18	11	210	90	60	0.42	84
70	1:20	211	117	195	130	70	190	150	150	115	20	15	240	105	65	0.77	139
80	1:30	233	129	210	140	80	220	170	180	135	24	15	270	120	70	1.18	20
100	1:40	286	160	260	170	100	270	190	220	155	25	15	340	150	90	2.31	35
120	1:50	349	180	290	190	120	320	230	260	180	30	18	405	180	105	3.2	58
135	1:60	373	201	320	210	135	350	250	290	200	30	18	465	215	105	4.1	79

Size	Ratio	Input Bore			Input Adapter				Output Shaft				Power	
		R	RD	RE	N <sub>(H7)</sub>	NA	NC	NG	NH	S <sub>(h6)</sub>	SB	SD		SE
50	1:10	11	12.8	4	110	160	130	10	5	17	40	19	5	0.25HP
	1:15	11	12.8	4	110	160	130	10	5	17	40	19	5	0.25HP
60	1:20	14	16.3	5	110	160	130	10	5	22	50	25	7	0.5HP
	1:30	14	16.3	5	110	160	130	10	5	22	50	25	7	0.5HP
70	1:40	19	21.8	6	130	200	165	12	5	28	60	31	7	1HP
	1:50	19	21.8	6	130	200	165	12	5	28	60	31	7	1HP
80	1:60	24	27.3	8	130	200	165	12	5	32	65	35	10	2HP
	1:60	24	27.3	8	130	200	165	12	5	32	65	35	10	2HP
100	1:60	28	31.3	8	180	250	215	15	5	38	75	41	10	3HP
	1:60	28	31.3	8	180	250	215	15	5	38	75	41	10	3HP
120	1:60	28	31.3	8	180	250	215	15	5	45	85	45	12	5HP
	1:60	28	31.3	8	180	250	215	15	5	45	85	45	12	5HP
135	1:60	38	41.3	10	230	300	265	15	5	55	95	60	15	5HP
	1:60	38	41.3	10	230	300	265	15	5	55	95	60	15	7.5HP